

COPYRIGHT 2021 GALLO HERBERT ARCHITECTS
FOR ANY PERSON UNLESS ACTING UNDER THE DIRECTION OF A LICENSED ARCHITECT TO ALTER THESE PLANS AND SPECIFICATIONS, THIS DOCUMENT CONTAINS PROPERTY INFORMATION AND SHALL NOT BE USED OR REPRODUCED, OR ITS CONTENTS DISCLOSED, IN WHOLE OR IN PART, WITHOUT THE PRIOR WRITTEN CONSENT OF GALLO HERBERT ARCHITECTS.
THESE PLANS AND SPECIFICATIONS SHALL BE USED IN CONJUNCTION WITH THE DETAILED DIMENSIONS AND CORRELATE DIMENSIONS PROVIDED IN THESE DRAWINGS, AND SHALL PROMPTLY NOTIFY THE DESIGNER OF ANY DISCREPANCIES.

NFPA LIFE SAFETY DATA	FLORIDA BUILDING CODE DATA
FLORIDA FIRE PREVENTION CODE, SEVENTH EDITION INCLUDING NFPA, 1 FIRE CODE AND NFPA 101, LIFE SAFETY CODE, 2018 EDITION	FLORIDA BUILDING CODE 2020- SEVENTH EDITION
NEW AIRCRAFT HANGAR STORAGE OCCUPANCY CHAPTER 42 ORDINARY HAZARD BUILDING IS NOT FULLY SPRINKLERED	USE AND OCCUPANCY S-1 AIRCRAFT STORAGE HANGAR CHAPTER 3
NFPA 42.6 SPECIAL PROVISIONS FOR AIRCRAFT HANGARS	SPECIAL DETAILED REQUIREMENTS BASED ON USE & OCCUPANCY CHAPTER 4- 412- AIRCRAFT RELATED SPECIAL REQUIREMENTS
2 MEANS OF EGRESS REQUIRED FROM ALL AIRCRAFT HANGAR AREAS.	[F] 412.4.6.1 HAZARDOUS OPERATIONS GROUP III AIRCRAFT HANGAR ACCORDING TO TABLE 412.4.6 THAT CONTAINS HAZARDOUS OPERATIONS INCLUDING, BUT NOT LIMITED TO, THE FOLLOWING SHALL BE PROVIDED WITH A GROUP I OR II FIRE SUPPRESSION SYSTEM IN ACCORDANCE WITH NFPA 409 AS APPLICABLE.
EXITS FROM AIRCRAFT STORAGE AREAS SHALL BE AT INTERVALS NOT EXCEEDING 150 FT.	1. DOPING.
HORIZONTAL EXITS AT FIRE BARRIERS SHALL NOT EXCEED 100 FT. SPACING.	2. HOT WORK INCLUDING, BUT NOT LIMITED TO, WELDING, TORCH CUTTING AND TORCH SOLDERING
"SMASH DOORS" NOT APPLICABLE	3. FUEL TRANSFER.
MEZZANINES NOT APPLICABLE.	4. FUEL TANK REPAIR OR MAINTENANCE NOT INCLUDING DEFUELED TANKS IN ACCORDANCE WITH NFPA 409, INERTED TANKS OR TANKS THAT HAVE NEVER BEEN FUELED.
DEAD ENDS SHALL NOT EXCEED 50 FT. FOR NON HIGH HAZARD AREAS.	5. SPRAY FINISHING OPERATIONS.
MAXIMUM COMMON PATH OF TRAVEL- ORDINARY HAZARD, UN-SPRINKLERED = 50 FT	6. TOTAL FUEL CAPACITY OF ALL AIRCRAFT WITHIN THE UNSPRINKLERED SINGLE AREA IN EXCESS OF 1,600 GALLONS (6057 L).
DEAD END 50 FT. MAX.	7. TOTAL FUEL CAPACITY OF ALL AIRCRAFT WITHIN THE MAXIMUM SINGLE FIRE AREA IN EXCESS OF 7,500 GALLONS (28 390 L) FOR A HANGAR WITH AN AUTOMATIC SPRINKLER SYSTEM IN ACCORDANCE WITH SECTION 903.3.1.1.
MAXIMUM TRAVEL DISTANCE TO EXITS ORDINARY HAZARD, UNSPRINKLERED=200 FT MAX	GENERAL BUILDING HEIGHTS AND AREAS CHAPTER 5- ALLOWABLE HEIGHT TYPE IIIB N.S. 55 FT.
UNPROTECTED VERTICAL OPENINGS NOT APPLICABLE	STORIES ABOVE GRADE PLANE S-1, N.S. = 3 MAX
INTERIOR WALL AND CEILING FINISHES-PER REQUIREMENTS	BUILDING AREA, S-1, N.S. = 17,500
DETECTION ALARM & COMMUNICATION NOT REQUIRED	AREA MOD. FOR BUILDING A FRONTAGE ALLOWED $L_{front} = f/p - 0.25 \times W/30 = .75$ THEREFORE $17,500 \times 1.75 = 30,625$ S.F.
NFPA 409 STANDARD ON AIRCRAFT HANGERS	TYPE CONSTRUCTION: IIIB
GROUP III HANGAR TYPE III(200) CONSTRUCTION TYPE PER NFPA 220	CH 6 FIRE RATED EXTERIOR WALLS S-1 OCC, X IS GREATER THAN
HANGAR DOORS LESS THAN 28 FT. HIGH	OR EQUAL TO 30 FT ALLOW ZERO HOUR RATED EXT WALLS.
MAXIMUM FIRE AREA LESS THAN 12,000 S.F.	
BUILDING UNSPRINKLERED AS ALLOWED AS ORDINARY HAZARD PER FBC 412.4.6.1	

EMERGENCY RADIO SIGNAL / BI-DIRECTIONAL AMPLIFICATION

ALL BUILDINGS SHALL BE TESTED FOR EMERGENCY RADIO SIGNAL STRENGTH AFTER THE SHELL IS CONSTRUCTED. VERIFY WITH MUNICIPALITY FIRE DEPARTMENT FOR TESTING REQUIREMENTS PRIOR TO TESTING. IF THE BUILDING IS FOUND TO REQUIRE A B.D.A. (BI-DIRECTIONAL AMPLIFICATION SYSTEM) OWNER WILL ENGAGE A SPECIALTY ENGINEER TO DESIGN A BOOSTER SYSTEM IN FULL ACCORDANCE WITH NFPA 72 AND LOCAL AUTHORITIES HAVING JURISDICTION.

DETAILS OF CONSTRUCTION SUCH AS LOCATION OF HEAD END EQUIPMENT AND CABLE PATHWAYS VERTICALLY AND HORIZONTALLY SHALL BE SPECIFIED.

THE CONSTRUCTION DRAWINGS WILL INCLUDE PLANNING FOR POSSIBLE BDA EQUIPMENT LOCATION AND CONDUITS. BDA WILL BE IN A TWO HOUR FIRE RATED ROOM NOT LESS THAN 3' WIDE BY 5' LONG. VERTICAL CABLE CHASES IF NECESSARY WILL NEED TO PROVIDE 2 HOUR FIRE RATING. HORIZONTAL CABLE NEED NOT BE FIRE RATED. CABLE AND EQUIPMENT SHALL NOT BE LOCATED IN STAIRS

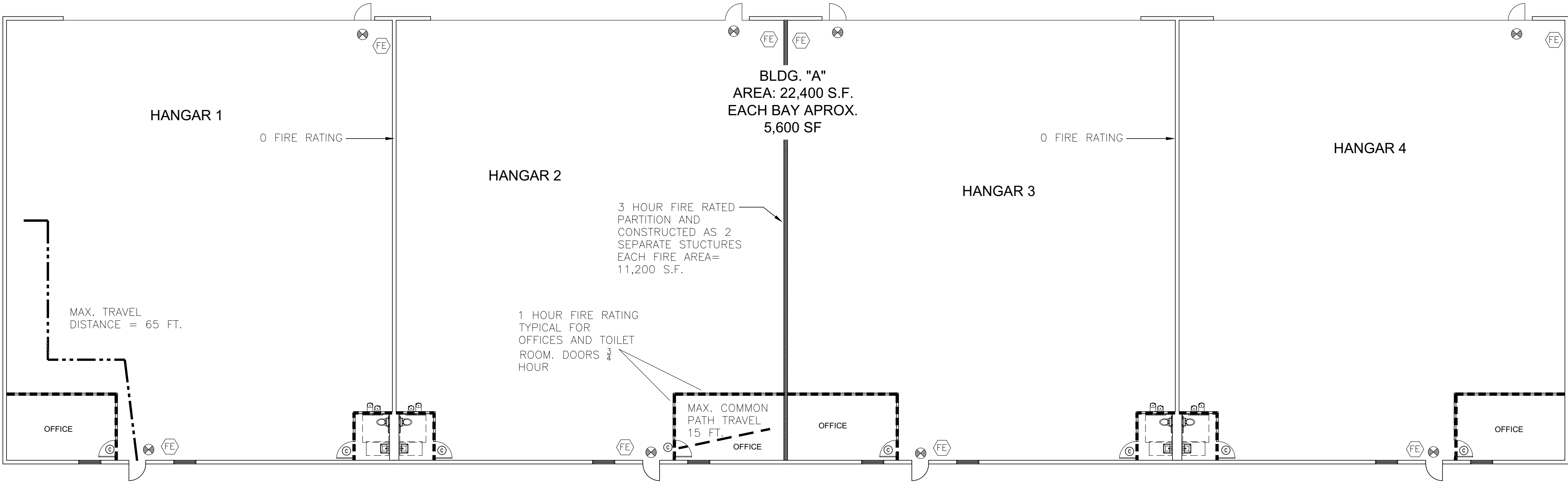

A4 BUILDING A LIFE SAFETY PLAN
3/32" = 1'-0"

GENERAL NOTES:
UN-SPRINKLERED
RESISTANCE RAY
DOOR LABEL
90 MIN FIRE LABEL DOOR
45 MIN FIRE LABEL DOOR
20 MIN FIRE LABEL DOOR

LEGEND
TRAVEL DISTANCE PATH
COMMON PATH
DEAD-END CORRIDOR
CLG. MTD. DIRECTIONAL EXIT SIGN
WALL MTD. EXIT SIGN
FIRE EXTINGUISHER - SEMI-RECESSED CABINET W/ 3A 4BC RATING
FIRE EXTINGUISHER - WALL MOUNTED W/BACKET W/ 3A 4BC RATING
F.D. KEY F.D. KEY BOX LOCATION (VERIFY W/ F.D. MANUF. TYPE KNOX OR SUPRA)
EMERGENCY LIGHT

EGRESS DATA FBC S-1 OCC
OCCUPANCY LOAD
S-1
MAX. TRAVEL DISTANCE TO EXIT (FT)
200'
MAX. DEAD END CORRIDOR
20'
MIN. CORRIDOR WIDTH
44"
MIN. CLEAR OPENING
32"
MAX. COMMON PATH (FT)
50'

OCCUPANCY LOAD SUMMARY FBC CH 10
OCCUPANCY CLASSIFICATION: GROUP S-1
CAPACITY PER F.B.C 1004.5 AIRCRAFT HANGARS 1 PER 500 GROSS
EACH HANGAR IS 5600 SF THEREFORE OCCUPANT LOAD IS 5600 / 500= 11.2 THEREFORE 13 PEOPLE EACH BAY.

INTERIOR FINISH CLASSIFICATION LIMITATIONS
OCCUPANCY S-1 UN-SPRINKLERED
WALL AND CEILING
EXITS
CORRIDORS
OTHER SPACES
CLASS A- FLAME SPREAD 0-25
CLASS B- FLAME SPREAD 26-75
CLASS C- FLAME SPREAD 76-200
FLOORS
CLASS I OR II ARE PERMITTED
CLASS I- CRITICAL RADIANT FLUX, NOT LESS THAN 0.45 W/cm2
CLASS II- CRITICAL RADIANT FLUX, NOT LESS THAN 0.22 W/cm2 BUT NOT LESS THAN 0.45

LIFE SAFETY SYMBOLS

COMMON PATH OF TRAVEL

DEAD END

MAXIMUM TRAVEL DISTANCE

EXIT SIGNS, WITH OR WITHOUT DIRECTION ARROWS

EMERGENCY LIGHTS

FIRE EXTINGUISHERS DISTRIBUTED PER REQUIREMENTS ON ALL LEVELS.

COMMON PATH OF TRAVEL
DEAD END
MAXIMUM TRAVEL DISTANCE
EXIT SIGNS, WITH OR WITHOUT DIRECTION ARROWS
EMERGENCY LIGHTS
FIRE EXTINGUISHER 2A-10B:C 5 LB.



WILLIAM J. GALLO FL AR0008440

Brian Herbert
Digitally signed by Brian Herbert
Date: 2022.06.30 14:33:42 -04'00'
BRIAN P. HERBERT FL AR0015474 PROJECT

POMPANO BEACH AIR PARK PARCEL Y

601 NE 10TH ST.
POMPANO BEACH
FL 33060
OWNER

POMPANO BEACH

COMPANY NAME

REVISIONS

No.	Description	Date
B	D.R.C. SUBMITTAL	2022-06-28

PROJECT STATUS

D.R.C.

DATE

2021-03-24

PROJECT NUMBER

83-2020

SCALE

AS SHOWN

DRAWN BY JET CHECKED BY JET
DRAWING TITLE

BLDG. "A"
LIFE SAFETY PLAN

DRAWING NUMBER
A-A102

PZ22-12000020
10/19/2022

PZ22-12000020
9/21/2022

PZ22-12000020
8/3/2022